



DOUBLE.A

# Sliding Lid Desk Socket

## STS-SC01-Qi



Smooth Sliding Lid Operation



15W Wireless Charging



Support All Qi-Enabled Devices



Stylish & Discreet Appearance



Customizable Length



Meeting room



Study room



Office



# Sliding Lid Desk Socket



**Smooth** Sliding Lid  
Operation



**Stylish & Discreet**  
Appearance



**15W**  
Wireless Charging



**Customizable** Length



**Magnetic** Lock

# Sliding Lid Desk Socket

## Structure chart

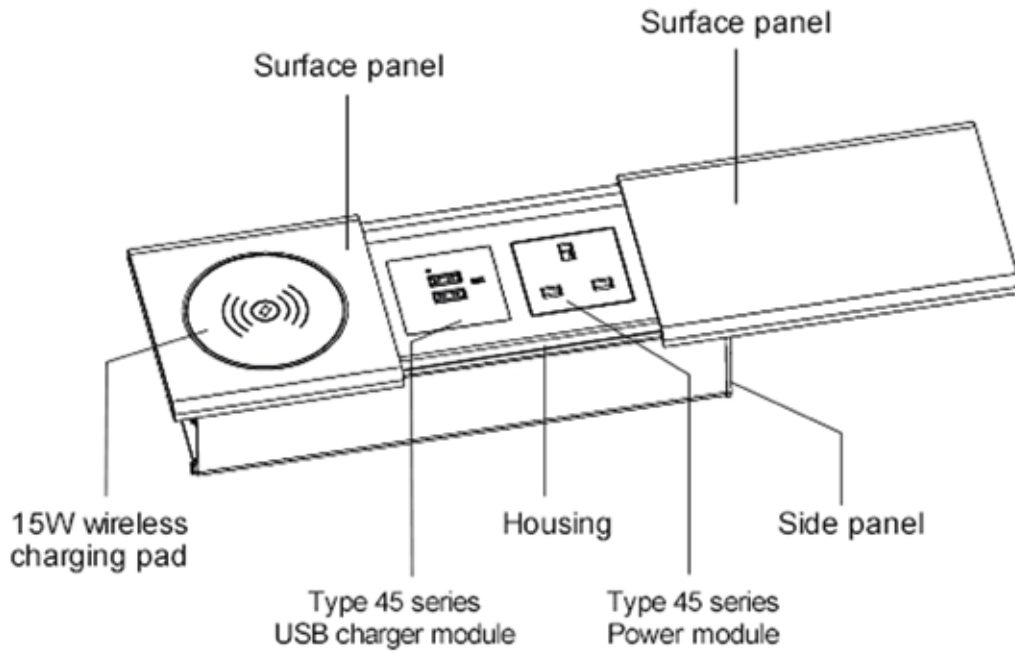

## Dimension

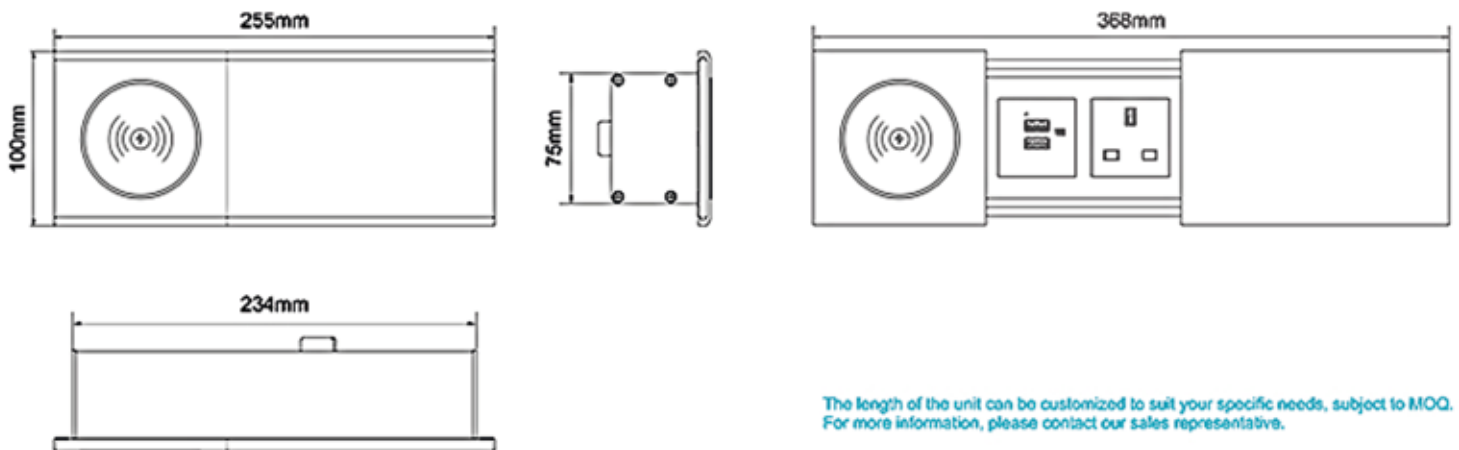



# Sliding Lid Desk Socket

DOUBLE.A

STS-SC01-Qi Sliding lid desk socket

OVERVIEW

Model No	STS-SC01-Qi
Colors	White/ Black/ Silver
Surface Panel Material	Aluminum alloy
Bottom Box Material	PVC
Module Capacity	4 (Unit length customizable. Subject to MOQ)
Cutout (mm)	237×77
Wireless Charging	Output 15W max
Input Voltage	9V
Input Current	1.67A
Power Cable Length	2 meters (customizable)
Opening Mechanism	Sliding lid panel

## Operation Instruction

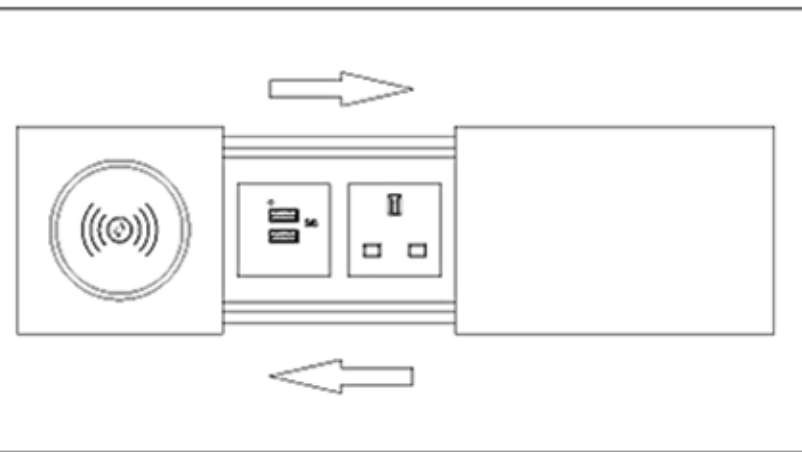

### Accessing power outlets

Slide open the lid to access the power outlets.  
Slide back the lid to conceal the power outlets when not in use.

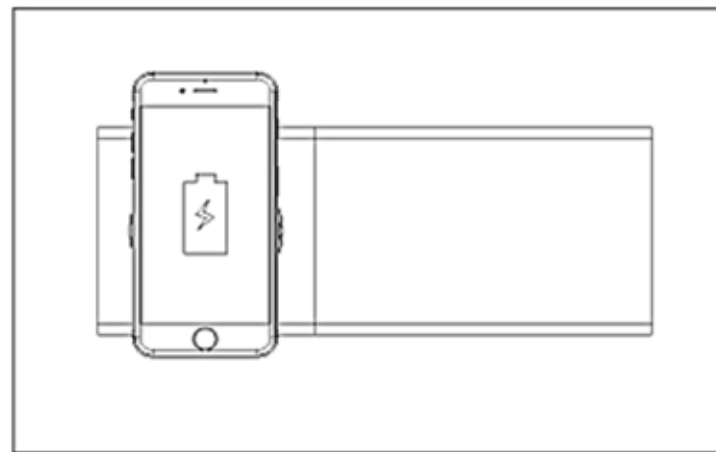

### Wireless Charging

Place the device gently on the top of cover and charge, compatible with all Qi enabled devices. Make sure the center of the device is aligned over the center of the charging base.